

Palm Springs Convention Center

277 North Avenida Caballeros, Palm Springs, California 92262
 (760) 325-6611; 1-800-333-7535 • www.palmspringscc.com

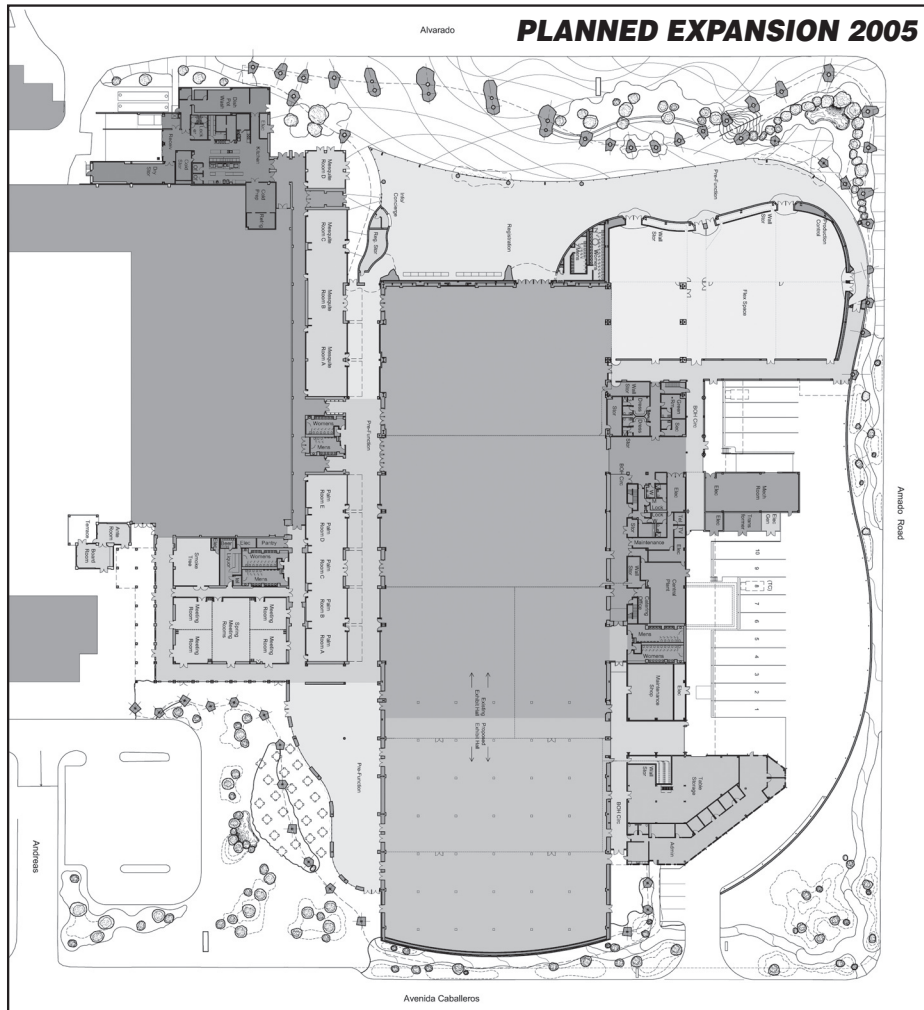

MEETING PLANNER



Name of Room	Dimensions (LxWxH)	Square Feet	Theater	Classrooms	Reception	Banquet	8'x10'	10'x10'
Oasis Hall 1	105x105x26	10,725	1,200	715	1,500	750	71	57
Oasis Hall 2	105x75x26	7,525	850	500	1,000	520	43	35
Oasis Hall 3	120x180x26	21,600	2,500	1,400	3,000	1,430	136	120
Oasis Hall 4	120x180x30	21,600	2,500	1,400	3,000	1,430	131	116
Oasis Hall 5	75x60x24	4,356	450	300	640	260	—	—
Oasis Hall 1-5	Irregular	66,000	—	—	9,140	4,390	411	351
Palm A-E (each)	30x30x10	900	90	50	65	50	—	—
Palm A-E	150x30x10	4,500	440	245	390	250	—	—
Mesquite A & B (each)	30x60x10	1,800	185	120	120	100	—	—
Mesquite C	30x30x10	900	90	50	65	50	—	—
Mesquite D	30x28x10	850	90	50	65	50	—	—
Mesquite A-C	150x30x10	4,500	460	290	305	250	—	—
Smoke Tree	—	1,200	100	60	90	60	—	—
Springs A, B, D, E (each)	—	700	50	35	40	35	—	—
Springs C	—	1,475	80	60	70	60	—	—
Springs A-E	—	4,333	280	200	230	200	—	—
PLANNED EXPANSION 2005								
New Oasis A, B	—	17,000	1,640	970	2,000	970	—	—
New Ballroom (6 Sections)	—	21,000	1,750	980	2,100	980	—	—
West Lobby	—	18,000	—	—	—	—	—	—
East Lobby	—	6,000	—	—	—	—	—	—

• Facility equipped with high-speed networking capability with CAT-5 and fiber-optic cabling • High-speed Internet access • Wireless capabilities

